

Boardwalk

Bromley Heath

DOWNEND, BRISTOL

Bromley Heath Road

DOWNEND

APPROXIMATE FLOOR AREA
148.3 SQM / 1597 SQFT

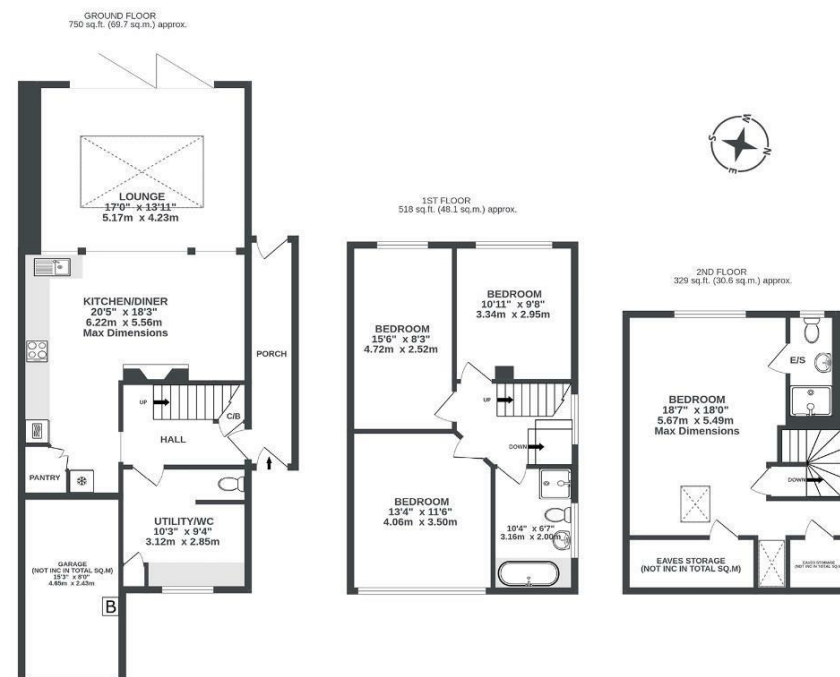

Illustrations are for reference purposes only, measurements are approximate, not to scale.

Boardwalk

Bromley Heath

DOWNEND, BRISTOL



£550,000



4 Bedrooms



BS16 6HZ



3 Bathrooms

"Bromley Heath is the place we hoped to live since moving to Bristol in 2012 and it did not disappoint. It has been a fantastic area to live especially with children. The schools are fantastic, the high street has independent shops and cafes, my children love the 'Freakshakes' at the Beehive and my husband and I have the best date nights at Mokka. We are so close to the cycle track which leads to a skate park and children's play area including a tennis court."

